

PLAN SHOWING THE PROPOSED THE L P G CYLINDER GO DOWN AT PLOT NO 155 156 157 & 158 SNO 78/2C & 78/3 VARGESN STREET OLD MAHALIPURAM ROAD ELLIM NAGAR PERUNGUDI PANJAYAT CHENNAI-96 FOR M/s L P G CYLINDER GO DOWN 8000 K.G CAP K.T.S ENTERPRISES

AREA DETAILS	SQ. FT	SQ. M
AREA OF THE SITE	7485.00	695.91
AREA OF THE GO DOWN	910.00	84.51
AREA OF OPEN SPACE OF GODOWN	6575.00	611.34

JOINERY DETAILS

D	M.S DOOR DOUBLE LEAF OPENING OUTWARDS 5.0 X 7.0 15X21 M
V	VENTILATORS 3.0 X 2.5 COVERED WITH TWO LAYERS OF BRASS GAUZE II MESH LINEAR CM PLASTERED BELOW TRUSS AND AT FLOOR LVL.
G	GATE 6.0 X 7.0 1.8 X 2.1 M
WG	WICKET GATE 4.0 X 7.0 1.22 X 2.10 M

SPECIFICATION

- ALL DIEMENSION ARE IN M & FT.
- NO INFLAMMABLE MATERIAL SHALL BE USED IN CONSTRUCTION
- NECESSARY CAUTION BOARDS FIRE FIGHTING EQUIPMENTS SHALL BE KEAP AT SITE
- FE 4 NOS FIRE EXTINGUISHERS PROVIDED.
- LOADING UNLOADING PLATEORM PROVIDED
- MASTIC FLOOR PROVIDED 25 M M TH
- SCALE 1:50 1:100 1:200
1"=20' 1"=80' 1"=160'

 INDIAN OIL CORPORATION LTD.
MARKETING DIVISION MADRAS AREA OFFICE

LTS. *S. S. Srinivasan*
KTS. *R. Srinivasan*
S. S. Srinivasan OWNER

P. Narayanasami Ph: 225389
P. NARAYANASAMI 2254535 OFF
CONSULTING CIVIL ENGINEER
LICENSED SURVEYOR
CORPORATION OF MADRAS
LICENCE NO: 21
28, Melapadi Muthu Street
Nungambakkam
MADRAS 500 034
LICENSED SURVEYOR

CMDA 'C'/PP No. /
C. No. *ca/6835/57*
Asst. _____
Serials: *10/9/57*
PART I
PART II
Km
A.P. *11/4*
D.P. _____

Planning Permit No *c/24562/60/57*
APPROVED
SUBJECT TO THE CONDITIONS IN THIS OFFICE LETTER.
R.C.C 1:2:4
SAND FILLING No. *2/6835/57* Date *2-5-57*
FOR MEMBER SECRETARY, CHENNAI METROPOLITAN DEVELOPMENT AUTHORITY
CHENNAI-600 008.

DETAILS OF FENCING & COMPOUND WALL
SCALE 1:50
2/5/57

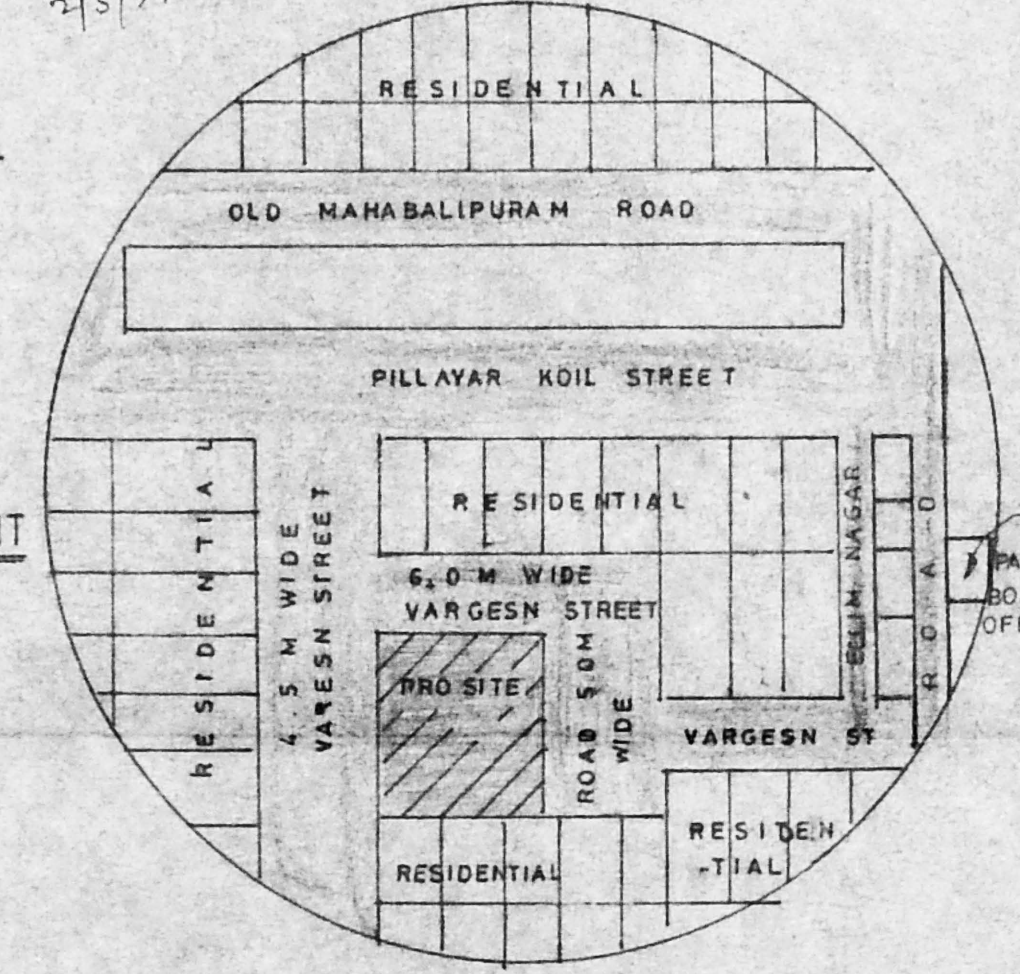
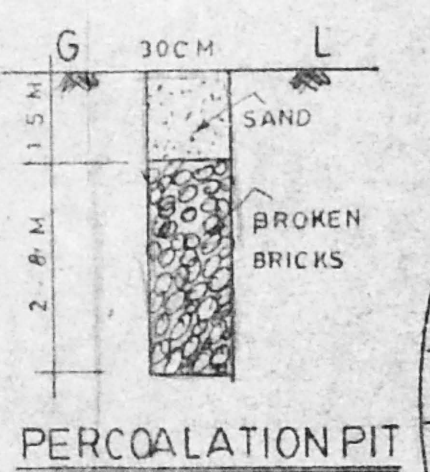

COLOUR INDEX

PROPOSED	
ROAD	
SITE BOUNDRY	

